

## **Stainless highlifter - hygiene at working height**

Focus on optimum hygiene - the stainless highlifters are developed for the use in environments with high hygiene demands. This is done in close cooperation with customers in industries where the trucks are exposed to an aggressive environment and thorough cleaning. With a stainless highlifter the risk of bacterial contamination is minimised.

High flexibility and efficiency - one product can transport and lift a pallet to the right working height.

The design prevents industrial injuries and strain on the user - focus is put on safety and ergonomics.

High quality is ensured through an extended test programme and in cooperation with experts in Health and Safety.



### Technical Specifications

Loads of 1,500 kg can be transported and lifted up to 470 mm with the high-lifter. From 470 mm the lifting capacity is 1,000 kg.

Easy to clean and optimum resistance

- acid-resistant and electric polished fork chassis (AISI 316L)

**HL RF-PLUS:** Stainless handle, legs and pump piston.

**EHL RF-PLUS:** IP54, stainless battery cover, legs, handle and cylinder housing.

**HL RF-SEMI:** Stainless handle, pump piston, axles and wheel holder. All other parts have a polymer plastic coating or are chromit-treated.

**EHL RF-SEMI:** Stainless handle, axles and wheel holder. All other parts have a polymer plastic coating or are chromit-treated. Battery indicator extra painted.

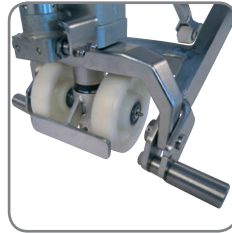

Optimum safety through supporting feet at steering wheel, foot protection and central location of all control buttons on the handle.



Closed forks mean easy cleaning and few hiding places for bacteria.



The manual highlifter is also available in an explosion proof version.

Product (measured in mm)	HL 1004RF-PLUS HL 1004RF-SEMI	EHL 1004RF-PLUS EHL 1004RF-SEMI
Capacity in kg	1500*	1500*
Lifting height	h <sub>3</sub> 800	800
Fork length	l 1200	1200
Overall height	h <sub>1</sub> 540	540
Fork span	b <sub>5</sub> 540, 680	540, 680
Length without forks	l <sub>2</sub> 340	445
Overall length	l <sub>1</sub> 1580	1645
Overall height with handle	h <sub>4</sub> 1220	1240
Lowered height	h <sub>13</sub> 90	90
Fork width	e 163	163
Turning angle of the wheels	210°	180°
Gangway	A <sub>st</sub> 1830 (pallet: 1200 x 800)	1890 (pallet: 1200 x 800)
Lifting speed with/without load		0,05/0,08 m/s
Lowering speed normal/quick	10/35 mm per pump	
Lowering speed	Without load 0,093 m/s	With/without load: 0,07/0,05 m/s
Pump motor		1,2 kW 12 V
Weight with 1140 mm forks (without battery)	125 kg	132 kg

\* The capacity changes from 1500 to 1000 kg at the lifting height 470 mm.



RF-PLUS - for the food industry and the pharmaceutical industry with severe demands for hygiene and cleaning.

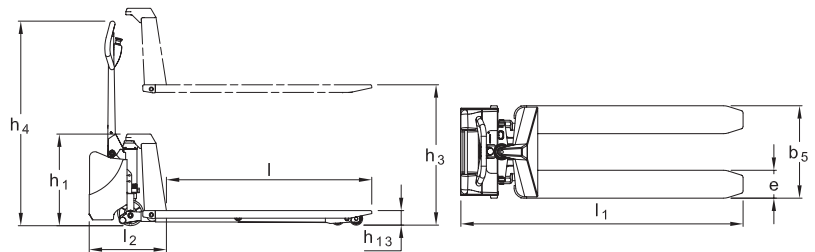

RF-SEMI - for the food industry in areas, where hygiene demands are not so high, but corrosion resistance important.



Ergonomic handle ensures the user a relaxed hold.



Remote control, also wireless, is available as optional extra (EHL).

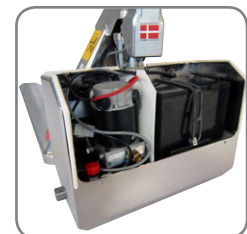

Watertight casing of the lifting motor (EHL RF-PLUS).

Please ask for specification details or visit our website [www.logitrans.com](http://www.logitrans.com). We also offer tailor-made solutions.